

B SERIES: Minimesse Sampling Valve

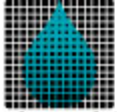

The Fluid Life Corporation
...because what happens on the inside really counts.







Head Office & Edmonton Laboratory
9321-48 St. Edmonton, Alberta T6B 2R4
Ph 780-462-2400 Fax 780-462-2420
Toll Free 1-877-962-2400

Ontario Laboratory
95 Copernicus Blvd. Brantford, ON N3P 2N4
Ph 519-720-9700 Fax 519-720-9705
www.fluidlife.com



Ideal For:

- Hydraulics
- Engines
- Transmissions
- Compressors
- Industrial
- Construction
- Marine
- Trucking

-  **Fast: Sample *pressurized* systems in seconds**
-  **Accurate: Taps hot active fluid.**
-  **Versatile: Pressure test to 6000psi.**
-  **Easy to use probe**
-  **Rugged metal cap with backup seal**
-  **Choice of threads and seal types**

Technical

Part#	A	B	C	Hex
B18N	1/8" NPT	1.34" 34mm	0.63" (16mm)	0.67" (17mm)
B14N	1/4" NPT	1.52" (38.64mm)	0.63" (16mm)	0.67" (17mm)
B716U	7/16" ORB	1.38" (34.97mm)	0.63" (16mm)	0.67" (17mm)
B916U	9/16" ORB	1.43" (36.23)	0.63" (16mm)	0.67" (17mm)

Ask about other metric and SAE port threads

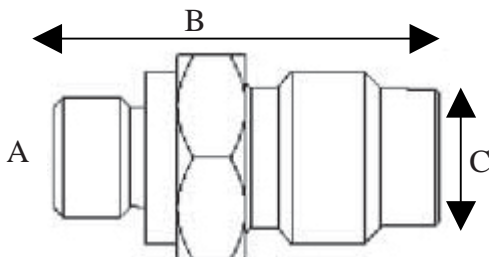

Operational

Specification	Value
Hand Sampling	-12psi to 750psi (-0.83 to 52bar)
Dynamic Sampling	-12psi to 5800psi (-0.83 to 400bar)
Max Operating Pressure	6000psi (414bar)
Max Burst Pressure	24000psi (1655bar)
Viton™ Seal Temperature	-15 to +400°F (-26 to 204°C)
Nitrile Seal Temperature	-40 to +240°F (-40 to 115°C)

Standard Materials

Component	Material
Body	Carbon Steel
Seal	Nitrile
Valve	Ball/Stainless Steel
Spring	Carbon Steel

Probe Devices

Port Adapter with Hose Barb

